

FALL PROTECTION



SAYFAGROUP.CO.UK

SAYFA 

FALLSECURE™ LINE

HORIZONTAL FALL RESTRAINT
SAFETY LINE SYSTEM

STATIC STRENGTH DYNAMIC REACTION SYSTEM

The Sayfa Group FallSecure™ Line (patent pending) provides a horizontal fall restraint or fall arrest solution, for individuals performing work at height.

With a patent pending, the post is both sufficiently rigid to prevent accidental deployment, but also at between 4kN and 6kN (the dynamic loads typically associated with a fall), the line post 'crumples' to prevent the forces being transferred to the roof structure.

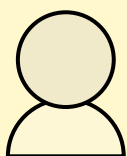

2 OR 3 USER
OPTION

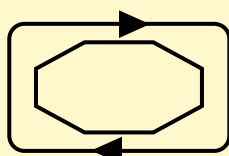

144M MAXIMUM
SYSTEM LENGTH



THIRD PARTY APPROVED
AND TESTED



Tested to 13kN by SATRA



EN795:2012 / BS8610:2017
Type C



316 grade components



12m bracket spacing



Non-Ferrous Post Brackets



PRODUCT INFORMATION

The FallSecure™ Line post is a two - three user system, rated at 13kN and tested by SATRA.

The FallSecure™ Line Posts are manufactured from 6082-T6 structural aluminium and 316 / A4 stainless steel. Available as standard at 150mm, 250mm, 350mm, 450mm, 550mm, and 650mm heights, to suit roof build up and provide suitable

clearance between the line and roof membrane.

The system components are supplied with a natural aluminium finish. However, the system can be anodised or polyester powder-coated to any standard RAL.

The 150mm-450mm post can be fixed with 80mm embedment in a min.115mm slab. The

550mm and 650mm posts can be fixed with 110mm embedment in a min. 150mm slab.

The system is made up of corner, in-line, cross over and end brackets as well as tension forks, short absorbers and line travellers.

For more information on the safety line and posts please contact us.

SAFETY LINE POSTS

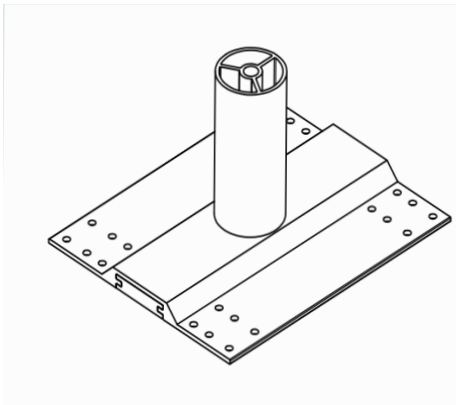

FSL-0325-0150-2U

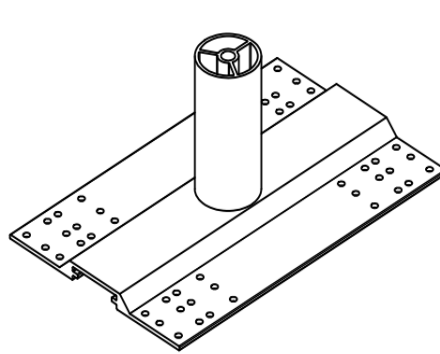

FSL-0425-0150-2U

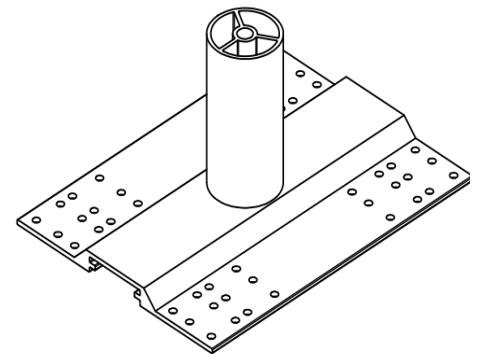

FSL-0360-0150-2U

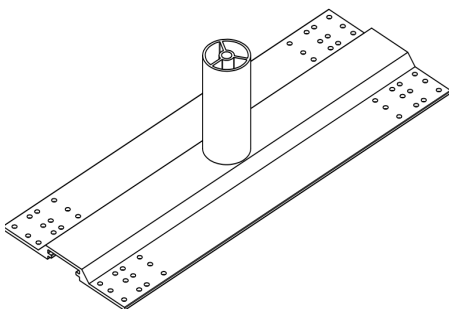

FSL-720-0150-2U

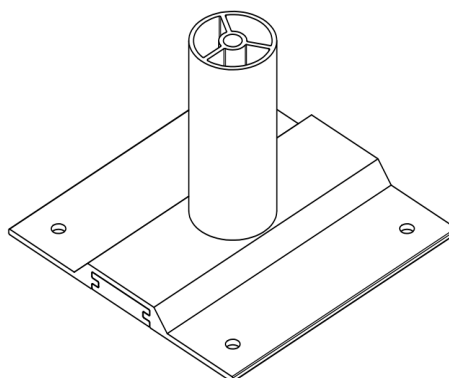

FSL-0270-0150-2U

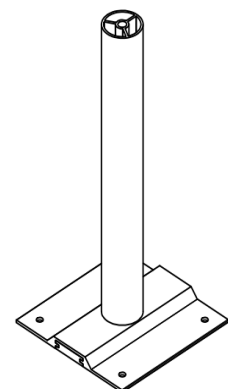

FSL-0270-0450-2U

SYSTEM ANCILLARIES

BRACKET / POST COMPONENTS



EPB.0000.SS
"End Post Bracket"



IPB.0000.SS
"Intermediate Post Bracket"



CPB.0000.SS
"Corner Bracket"



MEB.0200.AA
"Multi-End Bracket"

INLINE COMPONENTS



SAI.0000.SS
"Inline Shock Absorber"



SFT.0000.SS
"Inline Tensioner"



SFW.0000.SS
"Inline Fork"



LTP.0000.SS
"Line Traveller"

FIXINGS & RESIN



CAS.6617.SS



CAS.6620.SS



SPIT Viper Resin



Anchor Stud

TYPICAL WEATHERING & FIXING DETAIL



Boot Detail



Profile Metal Fixing



Pitch Pocket Detail

DESIGN & INSPECTION

Design of Roof Safety and Facade Access systems should be in accordance with BS7883:2019.

Sayfa Group products are independently tested and compliant to all current standards.

The ongoing use of these systems is subject to legislation that applies to the building owner or tenant. Operations and Lifting Equipment Regulations 1998 and The Provision and Use of Work Equipment Regulations 1998 apply.

All inspections of personal protective equipment should be in accordance with BS EN364:1993 and BS EN354:2010.

Please contact us for more information on testing and inspections.

“The range of roof safety and abseil solutions as well as service from Sayfa team, ensured this Grade I listed building maintained it’s architectural integrity. These John Nash neoclassical building can be safely maintained for many years to come”

Design Manager, Regents Crescent



GET IN TOUCH

SAYFAGROUP.CO.UK

ENQUIRIES@SAYFAGROUP.CO.UK

UNIT B1 - RESEARCH POINT
SHEPSHED,
LEICESTERSHIRE,
LE12 9NH

+44 1509 509 273

